



# Z3J Series Infrared Photoelectric Sensor

## Key technique parameters

checking mode	Through-beam mode		Reflex mode		
	Z3J-2C3	Z3J-3C3	Z3J-Ds30E3	Z3J-Ds50E3	Z3J-Ds100E3
checking distance	2 m	3 m	30 cm	50 cm	100 cm
voltage supply	DC10-30V ±10% wave<10%				
currency load	100mA(max)				
output voltage	$V_H \leq V_C - 1.5V$ $V_L \leq 1.2V$				
output mode	Operate with light or without light				
response time	1ms				
enviroment protection temperature	Work at -15°C~65°C Storage -25°C~80°C				
connection wire	φ5.4PVC 4-core cable L=2m				
shell material	Metal				

## Output

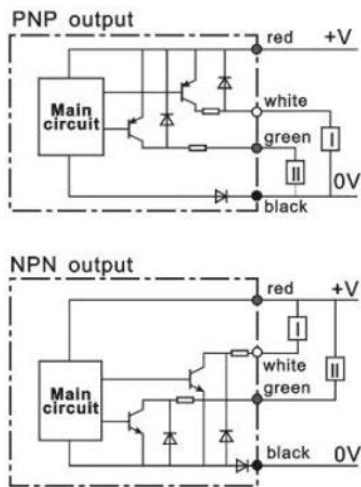

## Shell size

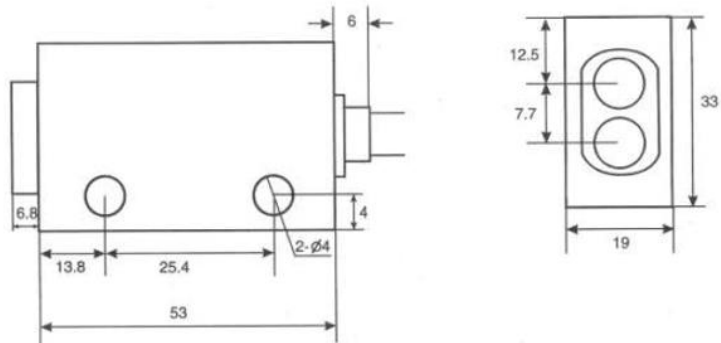

## Other

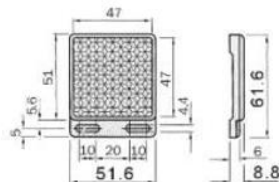

Reflectors (only: Reflex mode)  
Size: 47 x 47 mm

## Zhejiang Longyou JL Electronic CO.,LTD

Add: No.465 Renmin in South road, Lingjiang industrial Zone, Longyou county, Zhejiang Province,  
P.R.China Tel: +86(0)570 -7251076 Fax: +86(0)570 -7251079  
Mail: ljyardz@126.com Internet://www.JL-sensor.com